



Converter Accessory Corporation

201 Alpha Road PO Box 188 Wind Gap, PA 18091

www.converteraccessory.com
Email: sales@converteraccessory.com

Phone: (800) 433-2413
(610) 863-6008

Fax: (800) 709-1007
(610) 863-7818

COR-LOK® XE Series Pneumatic Chucks

CAC's COR-LOK® XE series pneumatic chucks feature a spiral wrapped external element, which inflates to contact your cores inside diameter. This unique design evenly grips your core. Light-weight chucks deliver the torque and stability required for the most demanding applications. Available for core sizes from 2–12 inches (chucks for 3 and 6 inch diameter cores are standard).

The contoured, rugged inflating tube is designed for long use between maintenance. However, this standard inflating tube is easily replaced in under 15 minutes when necessary.



COR-LOK air chuck dimensions									
To fit core size:	Deflated diameter	Inflated diameter	Bore range	Expanding length	Over all length	End cap valve end	End cap plain end	Core stop flange Ø	Approximate weight
3	2—31/32	3—3/16	Up to 2	5	8.5	2	1.5	3.25	3 LBS
6	5—31/32	6—3/16	Up to 5	5	8.5	2	1.5	6.25	13 LBS

All dimensions in inches



Converter Accessory Corporation

201 Alpha Road PO Box 188 Wind Gap, PA 18091

www.converteraccessory.com
Email: sales@converteraccessory.com

Phone: (800) 433-2413
(610) 863-6008

Fax: (800) 709-1007
(610) 863-7818

Inside CAC's COR-LOK® XE series core chucks

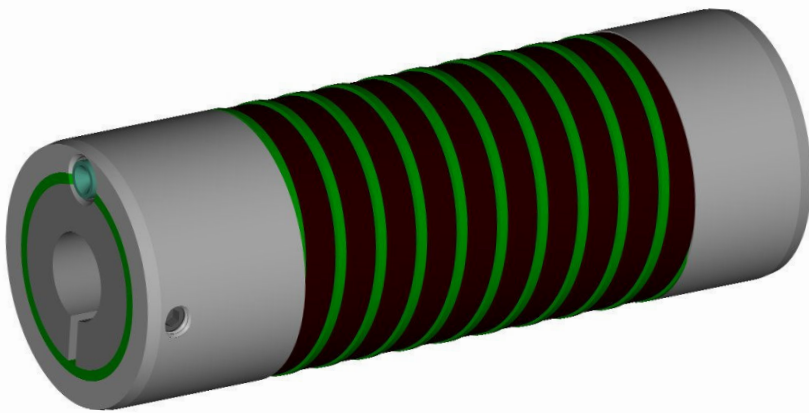
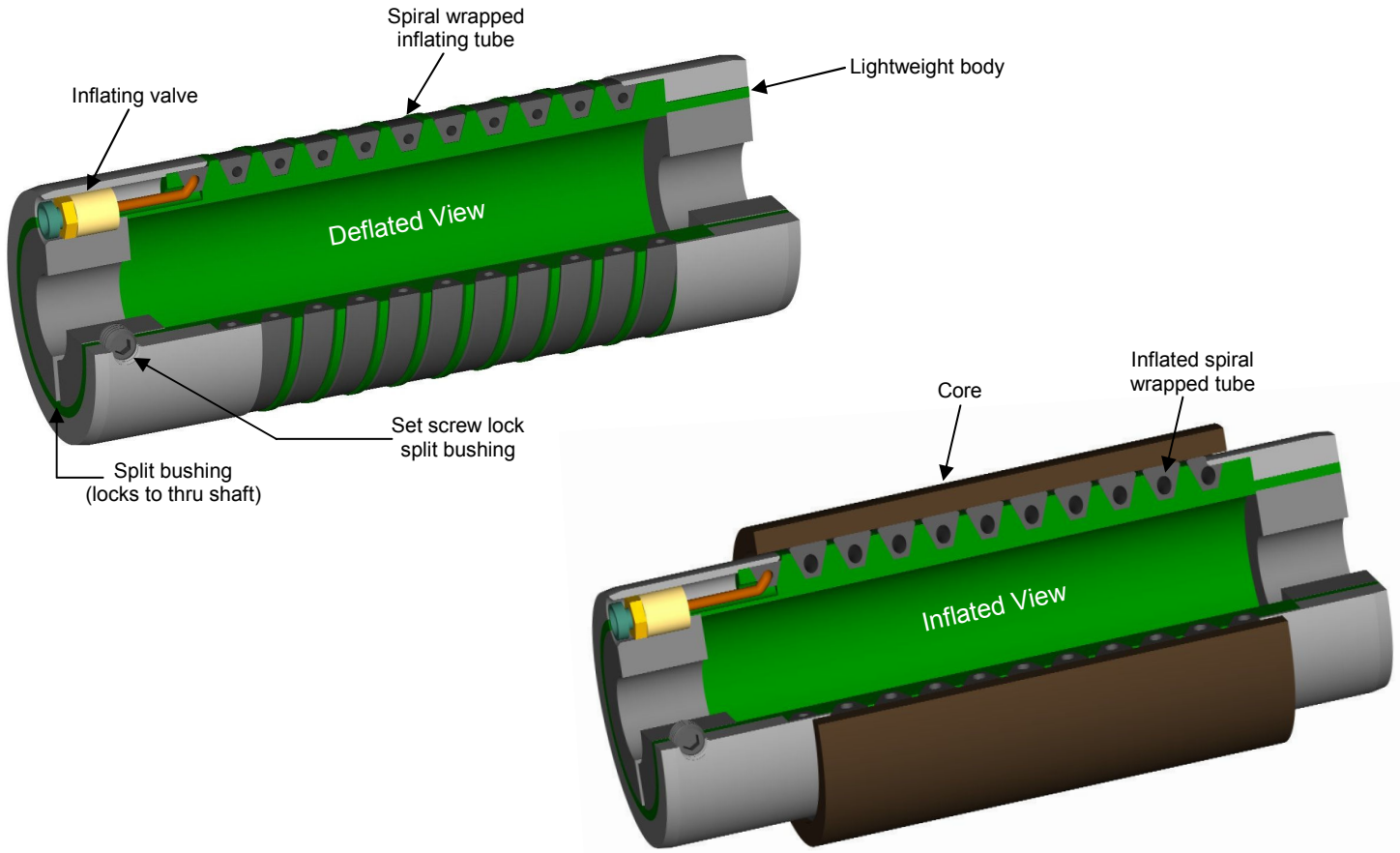

Visit www.converteraccessory.com to view and download specification sheets